

70-S-54 - SPEEDLINE System Data Sheet - Version V1 (24-10-23)

SPEEDLINE 70mm 'C' Stud Partition @600mm Ctrs,
with Siniat GTEC 15mm dB Board each side

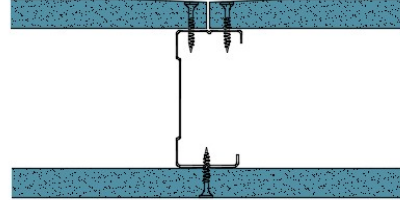

System Performance Breakdown

Fire Resistance:

BS476 Part 22:1987:

Test Ref & Date or Applied Ref & Report:

Max Height:

Thickness:

Duty Grade: BS 5234: Part 2:1992:

Sound Insulation:

30/30 Minutes (Integrity/Insulation).

BRE 269826 - BRE Report P102396-1011C

Refer to Speedline Specification Clause

102 mm. (At Base Track, Excluding Finishes)

Heavy - Annexes A-F

41 R_w dB, Date Tested or Assessed Against - 11/08/2011

Test Code:
H17528AA
Test Date:
11/08/2011

Freq. Hz	R dB
50	21.6
63	13.3
80	11.3
100	13.8
125	14.9
160	27.1
200	35.0
250	35.5
315	35.2
400	39.9
500	43.0
630	46.9
800	52.8
1 000	54.4
1 250	55.0
1 600	54.2
2 000	43.6
2 500	39.4
3 150	43.1
4 000	46.4
5 000	50.1
6 300	
8 000	
10 000	

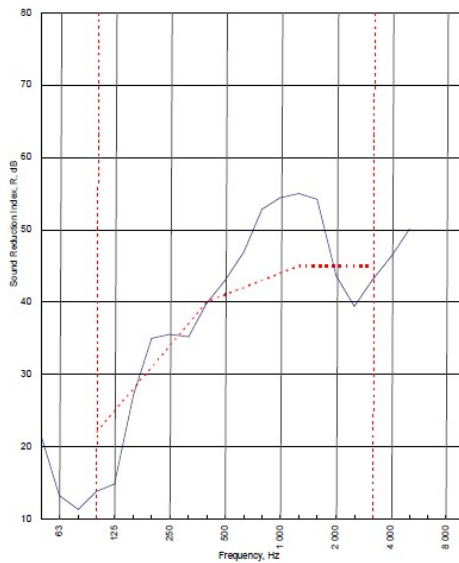

Rating according to BS EN ISO 717-1:1997	R_w (C;Ctr) = 41 (-4;-10) dB		
Evaluation based on laboratory measurement results obtained by an engineering method.	Max dev. 10.1 dB at 125 Hz		
	$C_{50-3150} = -5$ dB	$C_{50-5000} = -4$ dB	$C_{100-5000} = -3$ dB
	$C_{1,50-3150} = -13$ dB	$C_{1,50-5000} = -13$ dB	$C_{1,100-5000} = -10$ dB

TESTED AT ONE OF THE UKAS ACCREDITED LABORATORIES BELOW

B.T.C (H-Ref on Graph)

B.R.E

AIRO

S.R.L

Customer: Metsec plc Hepsec Division

BTC 17528A: Page 8 of 10

